

# SPEARHEAD

## ROTARY MOWER RANGE



## THE CUTTING PERFORMANCE YOU DESERVE

Spearhead has been at the forefront of vegetation control machinery for over three decades. You won't find a more dedicated manufacturer. We've listened to customer feedback and perfected our machines. They're robust, long-lasting, and highly efficient.

Since 1988, Spearhead has driven the European Rotary Mower market forward. Ensuring optimum cut quality, efficient fuel usage and greater productivity, we hope you'll be as impressed as our partners are.

With our rotary mower range we've set the standard for the industry. Anything less won't deliver the performance you deserve.

## CONTENTS

MULTICUT 160	6	MILITARY BUILDS	36
MULTICUT 200	8	MULTICUT 480 ARMY	38
MULTICUT 300	10	ARMY MASTER 530	40
MULTICUT 420	12		
MULTICUT 480 ECOLINE	14	WHAT SETS SPEARHEAD APART?	40
MULTICUT 480 PROLINE	16	MOUNTING SYSTEMS	42
MULTICUT 650 PROLINE	18	HITCH TYPES (TOWING EYES)	43
MULTICUT 660 HD	20	BLADE SYSTEMS	44
MULTICUT 830 PROLINE	22	DECK CONSTRUCTION	46
		DRIVELINES	46
STUBBLE MANAGEMENT SYSTEM	24	HYDRAGAS SUSPENSION	47
STUBBLE MASTER 500	26	WHEEL AND TYRE OPTIONS	47
STUBBLE MASTER 730	28	AXLE OPTIONS	48
STUBBLE MASTER 530 HD	30	HEIGHT ADJUSTMENT	48
STUBBLE MASTER 750 HD	32		
STUBBLE MASTER 930 HD	34	SPECIFICATIONS	49



## A ROTARY MOWER FOR EVERY REASON

When you want performance, whatever the terrain, Spearhead has your back. A globally respected brand, we design and build robust workhorses. Machines with the strength and ability to serve you, day in day out.

Designed and built in the UK, our Multicut and Stubble Master machines are robustly constructed. Seam welded and designed for a hard life we use strong gearboxes that deliver 30% more power than competitive alternatives. Running cooler, with oversized shafts and gears, they promise a longer service life too (backed by our 7-year gearbox warranty).

Achieve top-end performance by opting for features such as our award-winning six blade Starcut system, flat topskin, and hydragas suspension. In fact, numerous details help you create a mower that's always ahead of you.

With 15 different models, find your ideal working width from 1.6 metres to 9.3 metres. And match your tractor with either linkage mounted or trailed models - there's an ideal cutting machine for everyone.

**“When you're cutting pasture, Multicut delivers a uniform cut. The more you cut, the more you think it's a golf course! It's already made the quality of our pasture better. This has improved the health of our animals, giving us a higher milk yield and better beef production.”**

Robert Anyosa - Kilifi Plantations - Kenya

**“We worried that using a rotary topper would mean a rough job. But we intended to plough the ground and bury the trash anyway. In the event, we didn't need to because the Multicut 480 did such a good job. It pulverised everything so we could just cultivate the top and drill it.”**

Will Old - WW Old & Son - Northamptonshire

# MULTICUT 160



A heavy-duty vegetation control solution. With a 1.6 metre width, you won't find a tougher compact machine.

Three 12mm thick blades confidently cut and mulch scrub up to 100mm in diameter. Alternatively, opt for the chain kit when you have rocky terrain. Keeping stones in place, you'll avoid blade damage too.

Powered by our 165hp (123kW) gearbox (backed by a 7-year warranty), maximise your productivity in demanding environments.

- ▶ Compact machine ideal for challenging scrub.
- ▶ Choose between 12mm blades or chains.
- ▶ Work faster with our 165hp (123kW) gearbox.



TRACTOR POWER  
**40hp**  
(30kW)



CUT WIDTH  
**1.60m**  
(5' 3")



	<b>HP</b> TRACTOR HP	<b>KG</b> MINIMUM WEIGHT GUIDE	<b>A</b> TRANSPORT WIDTH	<b>FT IN</b> CUTTING WIDTH	<b>540 1000</b> PTO SPEED	<b>HP</b> GEARBOX RATING	<b>1</b> NUMBER OF WHEELS	<b>3</b> NUMBER OF ROTORS	<b>3</b> NUMBER OF BLADES	<b>50-250mm</b> (2" - 8") CUTTING HEIGHT
	40hp (30kW)	2900kg (6394lbs)	1.80m (5' 11")	1.60m (5' 3")	540rpm	165hp (123kW)	1	3	3	50 - 250mm (2" - 8")

OPTIONS



6 OR 21 SPLINE INPUT DRIVESHAFT



CHAIN CUTTING KIT

# MULTICUT 200



For more width, choose Multicut 200. Big sister to the 160, it handles the same, challenging jobs on scrub and moorland with a 2 metre cutting width.

Choose three 12mm blades or a heavy-duty chain cutting kit. When rocks are plentiful, chains prove a reliable option. Whatever set-up you need, this Multicut is built to be tough.

Attached via a floating linkage, the fully welded deck works hard for you, powering ahead with our 165hp (123kW) gearbox.

- ▶ A wider compact choice at 2 metres.
- ▶ Ideal for scrub, moorland, and rocky terrain.
- ▶ Robustly built for years of reliable service.

	HP	KG	TRANSPORT WIDTH	CUTTING WIDTH	PTO SPEED	HP				
	TRACTOR HP	MINIMUM WEIGHT GUIDE	TRANSPORT WIDTH	CUTTING WIDTH	PTO SPEED	GEARBOX RATING	NUMBER OF WHEELS	NUMBER OF ROTORS	NUMBER OF BLADES	CUTTING HEIGHT
<b>SPEARHEAD MULTICUT 200</b>	44hp (33kW)	2900kg (6394lbs)	2.10m (6' 10")	2.00m (6' 6")	540rpm	165hp (123kW)	1	1	3	50 - 250mm (2" - 8")



**HP**  
TRACTOR POWER  
**44hp (33kW)**

**CUT WIDTH**  
**2.00m (6' 6")**

OPTIONS



6 OR 21 SPLINE INPUT DRIVESHAFT

CHAIN CUTTING KIT

# MULTICUT 300



A true stalwart of the Spearhead range. The toughest machine of its type on the market. Tackling up to 100mm thickness, it delivers a professional finish, even in heavy scrub land applications.

This machine has twin rotors. With each handling two large 12mm thick steel blades, there are four in total. Coupled with our 165hp (123kW) gearbox, your productivity will go through the roof.

The trademark Multicut flat underside deck comes into its own as cutting width increases. Mulch spreads evenly with nothing to restrict it.

- ▶ 3 metre cut on the toughest terrains.
- ▶ Twin rotors (four blades) boost productivity.
- ▶ Flat underside ensures even mulch spread.

	TRACTOR HP	MINIMUM WEIGHT GUIDE	TRANSPORT WIDTH	CUTTING WIDTH	PTO SPEED	GEARBOX RATING	NUMBER OF WHEELS	NUMBER OF ROTORS	NUMBER OF BLADES	CUTTING HEIGHT
<b>SPEARHEAD MULTICUT 300</b>	50hp (37kW)	4000kg (8819lbs)	3.10m (10')	2.80m (9' 4")	1000rpm	165hp (123kW) & 130hp (97kW)	2	2	4	10 - 350mm (3/8" - 14")



**HP**  
TRACTOR POWER  
**50hp**  
(37kW)

**CUT WIDTH**  
**2.80m**  
(9' 4")

**OPTIONS**

**6** 6 OR 21 SPLINE INPUT DRIVESHAFT

**21** HEAVY-DUTY DRIVELINE

**SOLID LAMINATED WHEEL**

# MULTICUT 420



Popular within agriculture, Multicut 420 is perfect when access is tight. And yet you still have an excellent cutting width (4.2 metres) and relentless power.

Featuring a sturdy driveline, three rotors (each with three blades) operate at 80 metres per second. Coupled with our hardworking 100hp (75kW) gearbox, this is a high-performance mower.

Four heavy-duty wheels ensure stability, while inward folding wings reduce the transport width to 2.8 metres – ideal for narrow lanes. Plus, there's no need for an on-road towing kit as it's a linkage mounted machine.

- ▶ Ideal for smaller tractors with tight access.
- ▶ Fast mowing from nine blades over three rotors.
- ▶ Folding wings make transport a doddle.

TRACTOR HP	MINIMUM WEIGHT GUIDE	TRANSPORT WIDTH	CUTTING WIDTH	PTO SPEED	GEARBOX RATING	NUMBER OF WHEELS	NUMBER OF ROTORS	NUMBER OF BLADES	CUTTING HEIGHT
80hp (60kW)	5500kg (12126lbs)	2.80m (9' 2")	4.20m (13' 9")	1000rpm	100hp (75kW)	4	3	9	25 - 400mm (1" - 16")



TRACTOR POWER

80hp (60kW)



CUT WIDTH

4.20m (13' 9")



# MULTICUT 480 ECOLINE



Based upon the industry leading Multicut 460, the Multicut 480 Ecoline covers a huge area in no time. Popular with farmers, airports, and military organisations, performance matches build quality.

Nine steel blades make light work of any terrain and a new flat topskin (in addition to a flat underside) prevents debris build up. You won't transfer unwanted seeds to other crops and it's more energy efficient.

Mounting is simple with a fixed towing eye as standard with optional swivel and K80 versions a possibility. Folding wings make travel between locations easy.

- ▶ Fast mowing with a 4.6 metre cutting width.
- ▶ A flat topskin prevents debris build up.
- ▶ User-friendly trailing drawbar and folding wings.



TRACTOR POWER

70hp (52kW)



CUT WIDTH

4.60m (15' 1")



HP TRACTOR HP	TRANSPORT WIDTH	CUTTING WIDTH	PTO SPEED	GEARBOX RATING	NUMBER OF WHEELS	NUMBER OF ROTORS	NUMBER OF BLADES	CUTTING HEIGHT
70hp (52kW)	2.70m (8' 11")	4.60m (15' 1")	540 / 1000rpm	250hp (186kW) & 165hp (123kW)	8	3	9	25 - 400mm (1" - 16")

OPTIONS

<p>STANDARD TOWING EYES</p> <p>SWIVEL EYE K80</p>	<p>STARCUT BLADE SYSTEM</p>	<p>HYDRAGAS SUSPENSION</p>	<p>FRONT FLAP KIT</p>	<p>FRONT GUIDE WHEEL KIT</p>
---	-----------------------------	----------------------------	-----------------------	------------------------------



# MULTICUT 480 PROLINE

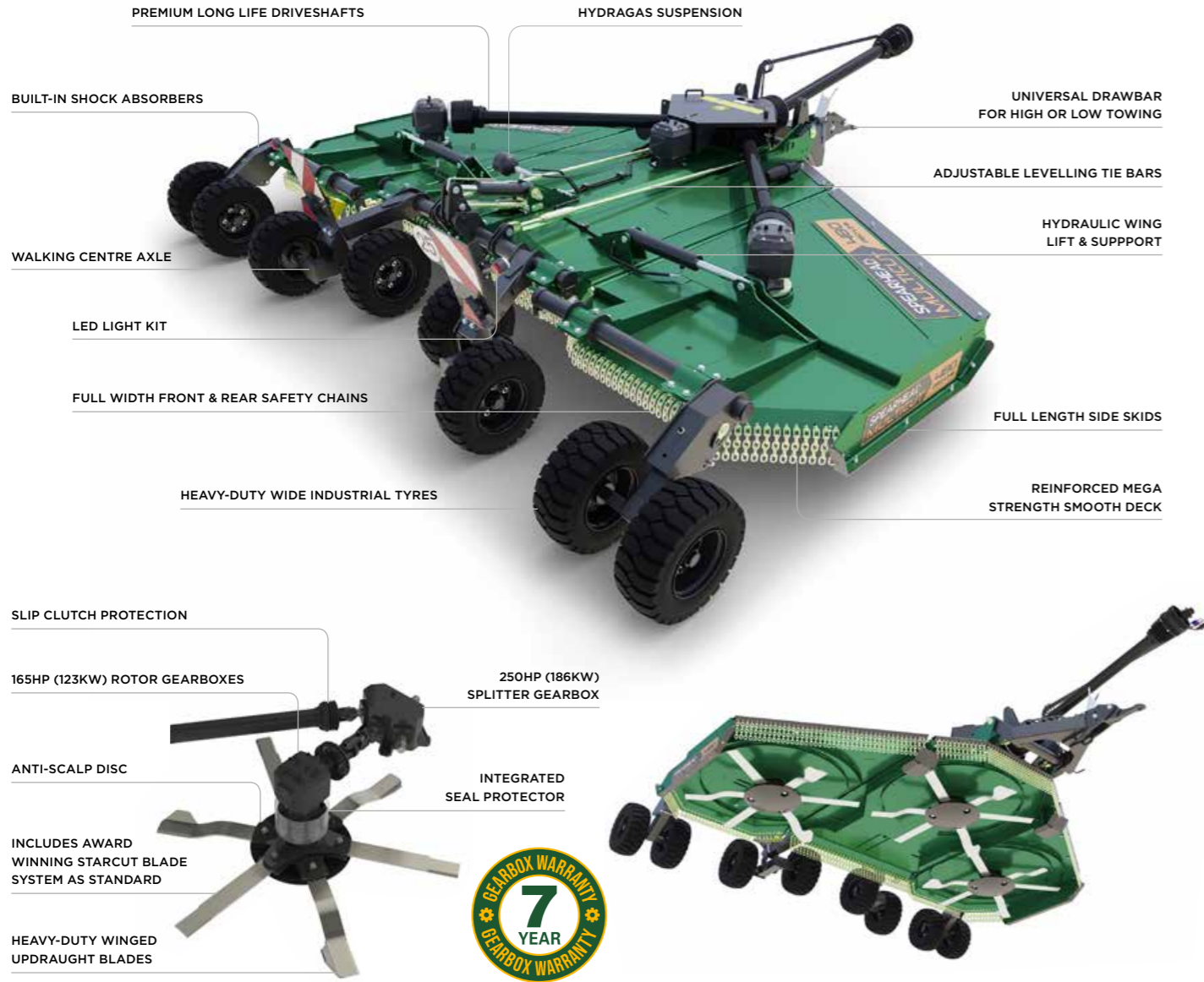

Building on our standard 480 Ecoline model, Proline boasts more features to give you top-notch performance in ultimate comfort. When you want the highest specification, choose a Proline model.

Hydragas suspension, a walking centre axle, and wide wheels reduce ground pressure - even in tough conditions. This ensures a comfortable ride for you and your tractor.

Meanwhile, our six-blade Starcut system comes as standard. Cut your stubble faster (with lower fuel costs) and accelerate mulch breakdown. All with a versatile 4.6 metre cutting width.

- ▶ Multicut boosted with exceptional spec.
- ▶ Hydragas suspension improves comfort.
- ▶ Six-blade Starcut system mulches faster.

<b>100hp</b> (75kW)	<b>2.70m</b> (8' 11")	<b>4.60m</b> (15' 1")	<b>540 / 1000rpm</b>	<b>250hp (186kW) &amp; 165hp (123kW)</b>	<b>8</b>	<b>3</b>	<b>18</b>	<b>25 - 210mm</b> (1" - 8 1/4")
------------------------	--------------------------	--------------------------	----------------------	--	----------	----------	-----------	------------------------------------



TRACTOR POWER

**100hp**  
(75kW)



CUT WIDTH

**4.60m**  
(15' 1")



## OPTIONS



6, 21 OR 8 SPLINE INPUT DRIVESHAFT



STANDARD SWIVEL EYE K80  
TOWING EYES



FRONT FLAP KIT

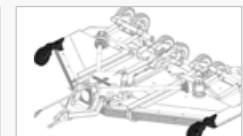

FRONT GUIDE WHEEL KIT

# MULTICUT 650 PROLINE



When you need fast, intensive output, Multicut 650 Proline won't let you down. Clearing over eight hectares per hour, it powers through your workload.

Five rotors, each with our renowned six-blade Starcut system, achieve far more than any other 6.3 metre mower. And with five rotor gearboxes, all with slip clutch protection (plus our 7-year warranty), this top performing Multicut delivers your every demand.

Your comfort is guaranteed thanks to hydragas suspension, a walking axle, and wider wheels. Plus, folding wings make road journeys easy.

- ▶ Rapid output guaranteed.
- ▶ 30 steel blades over five rotors.
- ▶ Endless features ensure a smooth ride.



TRACTOR POWER

**120hp (89kW)**



CUT WIDTH

**6.30m (20' 7")**



<b>TRACTOR HP</b>	<b>TRANSPORT WIDTH</b>	<b>CUTTING WIDTH</b>	<b>PTO SPEED</b>	<b>GEARBOX RATING</b>	<b>NUMBER OF WHEELS</b>	<b>NUMBER OF ROTORS</b>	<b>NUMBER OF BLADES</b>	<b>CUTTING HEIGHT</b>
120hp (89kW)	2.70m (8' 11")	6.30m (20' 7")	1000rpm	250hp (186kW) & 165hp (123kW)	8	5	30	25 - 210mm (1" - 8 1/4")

**OPTIONS**



6, 21 OR 8 SPLINE INPUT DRIVESHAFT



STANDARD SWIVEL EYE K80 TOWING EYES



FRONT FLAP KIT

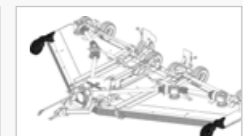

FRONT GUIDE WHEEL KIT

# MULTICUT 660HD



We designed this model with ultimate durability in mind. A heavy-duty mower, it's also ideal for wetter land and stubble management.

Easy to maintain, you'll welcome the flat topskin and single splitter gearbox guard. Plus, the wings fold to over-centre for stable road transportation.

Eight wide rugged wheels, hydragas suspension, and a high-strength walking axle improve floatation on tricky terrain. Tackling 6.4 metres in one pass, five rotors operate our six-blade Starcut system. This is performance personified.

- ▶ Heavy-duty performance mower and stubble manager.
- ▶ Enhanced floatation.
- ▶ Easy maintenance features.

<b>HP</b> TRACTOR HP	<b>2.50m</b> (8' 1")	<b>6.30m</b> (20' 9")	<b>1000rpm</b>	<b>250hp (186kW) &amp; 165hp (123kW)</b>	<b>8</b>	<b>5</b>	<b>30</b>	<b>25 - 210mm</b> (1" - 8' 1/4")
-------------------------	-------------------------	--------------------------	----------------	--	----------	----------	-----------	-------------------------------------



TRACTOR POWER

**120hp**  
(89kW)



CUT WIDTH

**6.30m**  
(20' 7")



OPTIONS



6, 21 OR 8 SPLINE INPUT DRIVESHAFT



STANDARD SWIVEL EYE K80 TOWING EYES

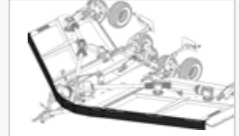

FRONT FLAP KIT



FRONT GUIDE WHEEL KIT

# MULTICUT 830 PROLINE

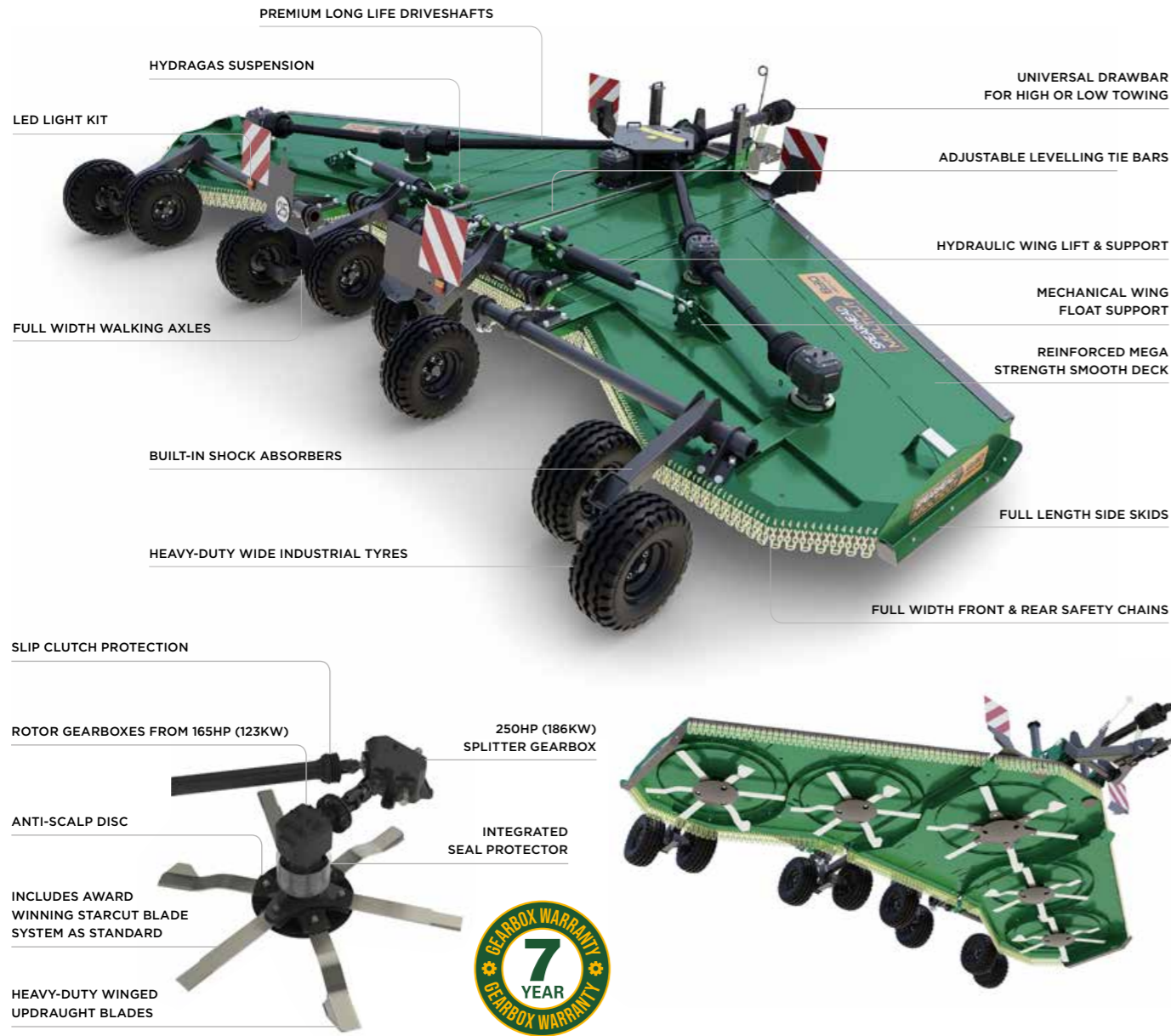

When you want to handle over 100 hectares a day, choose our largest Multicut. With an 8.3 metre working width, coupled with key Spearhead deck features output is certainly not a problem.

Giving you the perfect balance of performance and comfort, we've packed this giant Proline with features. Five rotors operate the six-blade Starcut system, and all five rotor gearboxes have slip clutch protection.

Everything about this machine delivers more. Like the hydragas suspension and extra-large wheels. And the flat topskin that prevents debris build-up. You'll enjoy the results after a day cutting the 830.

- ▶ Ultimate performance with an 8.3 metre working width.
- ▶ 30 Starcut blades over five rotors.
- ▶ Incredibly smooth ride from a giant machine.



**HP**  
TRACTOR POWER  
**150hp**  
(112kW)

**CUT WIDTH**  
**8.30m**  
(27' 1")



<b>HP</b> TRACTOR HP	<b>TRANSPORT WIDTH</b>	<b>CUTTING WIDTH</b>	<b>PTO SPEED</b>	<b>GEARBOX RATING</b>	<b>NUMBER OF WHEELS</b>	<b>NUMBER OF ROTORS</b>	<b>NUMBER OF BLADES</b>	<b>CUTTING HEIGHT</b>
150hp (112kW)	2.80m (9' 2")	8.30m (27' 1")	1000rpm	165hp (123kW) to 250hp (186kW)	8	5	30	25 - 400mm (1" - 16")

**OPTIONS**



# STUBBLE MASTER 500



Ideal for farmers and contractors who need a compact machine, the Stubble Master 500 provides a perfect balance.

Cutting five metres in one pass, it charges through your stubble - three rotors each handling six blades. Clever angles flare the material and promote faster decomposition.

Stubble Master boasts a monocoque structure. With an enhanced weight to strength ratio, it absorbs impact while improving fuel efficiency.

- ▶ A compact workhorse to support farmers and contractors.
- ▶ Angled blades speed up decomposition.
- ▶ Easy cleaning thanks to flat upper (and under) deck.

**HP**  
TRACTOR POWER  
**120hp**  
(89kW)

**CUT WIDTH**  
**5.20m**  
(17' 1")



<b>TRACTOR HP</b>	<b>TRANSPORT WIDTH</b>	<b>CUTTING WIDTH</b>	<b>PTO SPEED</b>	<b>GEARBOX RATING</b>	<b>NUMBER OF WHEELS</b>	<b>NUMBER OF ROTORS</b>	<b>NUMBER OF BLADES</b>	<b>CUTTING HEIGHT</b>
120hp (89kW)	3.00m (9' 9")	5.20m (17' 1")	1000rpm	250hp (186kW) & 165hp (123kW)	8	3	18	25 - 400mm (1" - 16")

**OPTIONS**

20, 6 OR 21 SPLINE INPUT DRIVESHAFT

STANDARD TOWING EYES K80

FRONT FLAP KIT REAR DRAWBAR KIT & HOSES AIR BRAKES

# STUBBLE MASTER 730



When you have more hectares to handle opt for a 7.3 metre machine. The 730 boasts the same specialist build as the 500, complete with a 165hp (123kW) gearboxes.

Larger farmers and contractors welcome five rotors in play. Each turns three flat and three angled blades to deliver Stubble Master's infamous double cut. This helps to speed up decomposition and improve your soil structure.

The monocoque deck design leaves nowhere for debris to collect, while the cutting height adjustment means you can cut within touching distance of the soil.

- ▶ Five rotors tackle 7.3 metres at once.
- ▶ Easy cleaning thanks to monocoque design.
- ▶ Finetune your cutting height for maximum output.

**HP**  
TRACTOR POWER  
**160hp**  
(119kW)

**CUT WIDTH**  
**7.30m**  
(23' 10")



<b>HP</b> TRACTOR HP	<b>3.00m</b> (9' 9")	<b>7.30m</b> (23' 10")	<b>1000rpm</b>	<b>250hp (186kW) &amp; 165hp (123kW)</b>	<b>8</b>	<b>3</b>	<b>30</b>	<b>25 - 400mm</b> (1" - 16")
-------------------------	-------------------------	---------------------------	----------------	--	----------	----------	-----------	---------------------------------

**OPTIONS**



# STUBBLE MASTER 530 HD

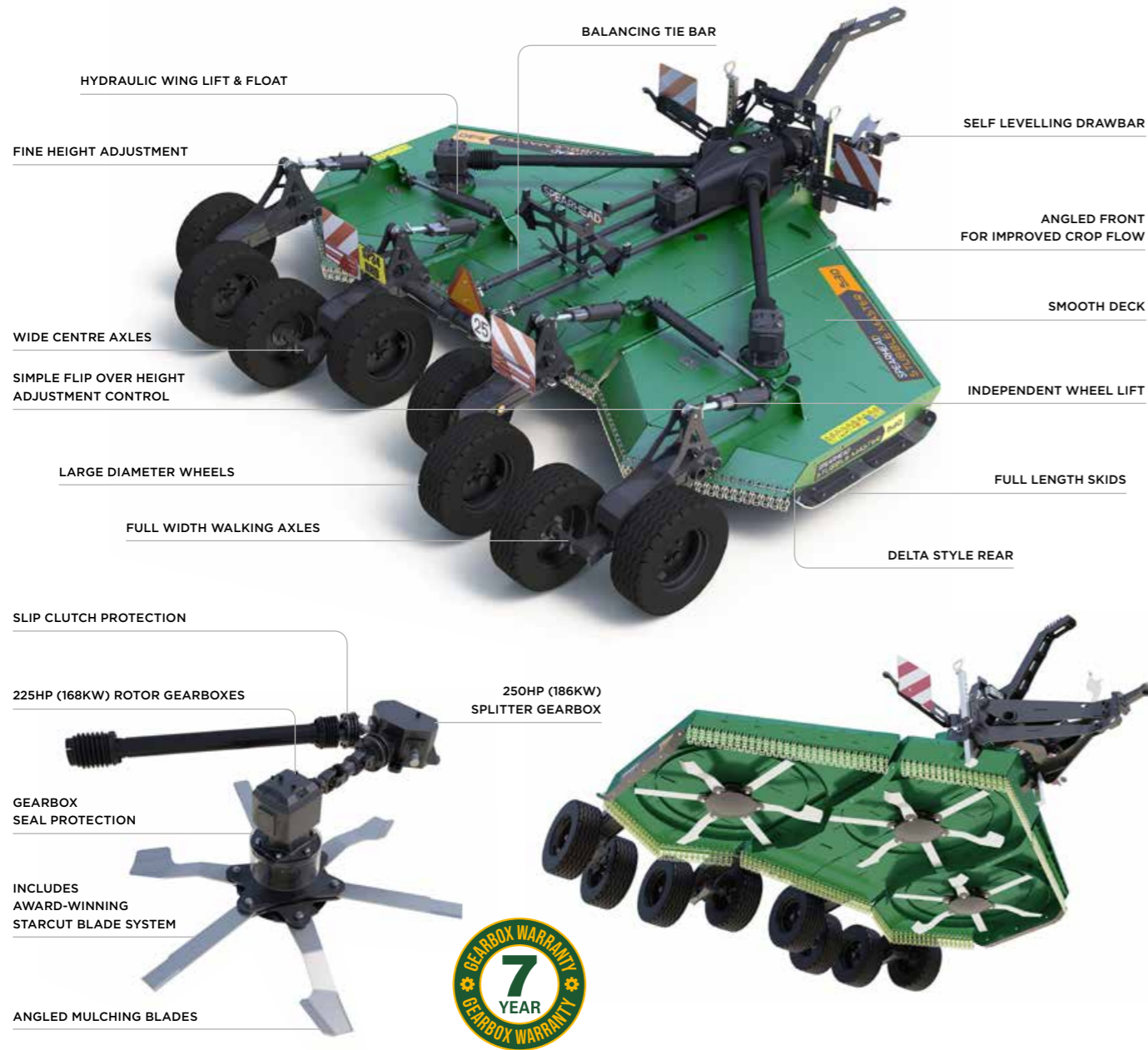

Commonly known as the “beefed up 500”, that’s not far off. A harder wearing design, it has a Hardox steel deck and a 225hp (186kW) driveline (compared to 165hp (123kW)). Everything about this compact machine is incredibly robust.

Radial tyres take challenging terrain in their stride, ensuring a smoother ride. Meanwhile a larger axle and drawbar make the 530 a tough little Stubble Master.

Grass seed farms welcome our high-end machines. When you’re intensively cutting three times a year, every efficiency counts.

- ▶ A heavy-duty, compact machine.
- ▶ 225hp (168kW) gearbox for additional power.
- ▶ Hard wearing specification.

<b>120hp</b> (89kW)	<b>3.00m</b> (9' 9")	<b>5.20m</b> (17' 1")	<b>1000rpm</b>	<b>250hp (186kW)</b> & <b>225hp (168kW)</b>	<b>8</b>	<b>3</b>	<b>18</b>	<b>25 - 400mm</b> (1" - 16")
------------------------	-------------------------	--------------------------	----------------	--	----------	----------	-----------	---------------------------------



**HP**  
TRACTOR POWER  
**120hp**  
(89kW)

CUT WIDTH  
**5.20m**  
(17' 1")

**OPTIONS**

- 20, 6 OR 21 SPLINE INPUT DRIVESHAFT
- STANDARD, SWIVEL EYE, K80
- FRONT FLAP KIT
- AIR BRAKES

# STUBBLE MASTER 750 HD

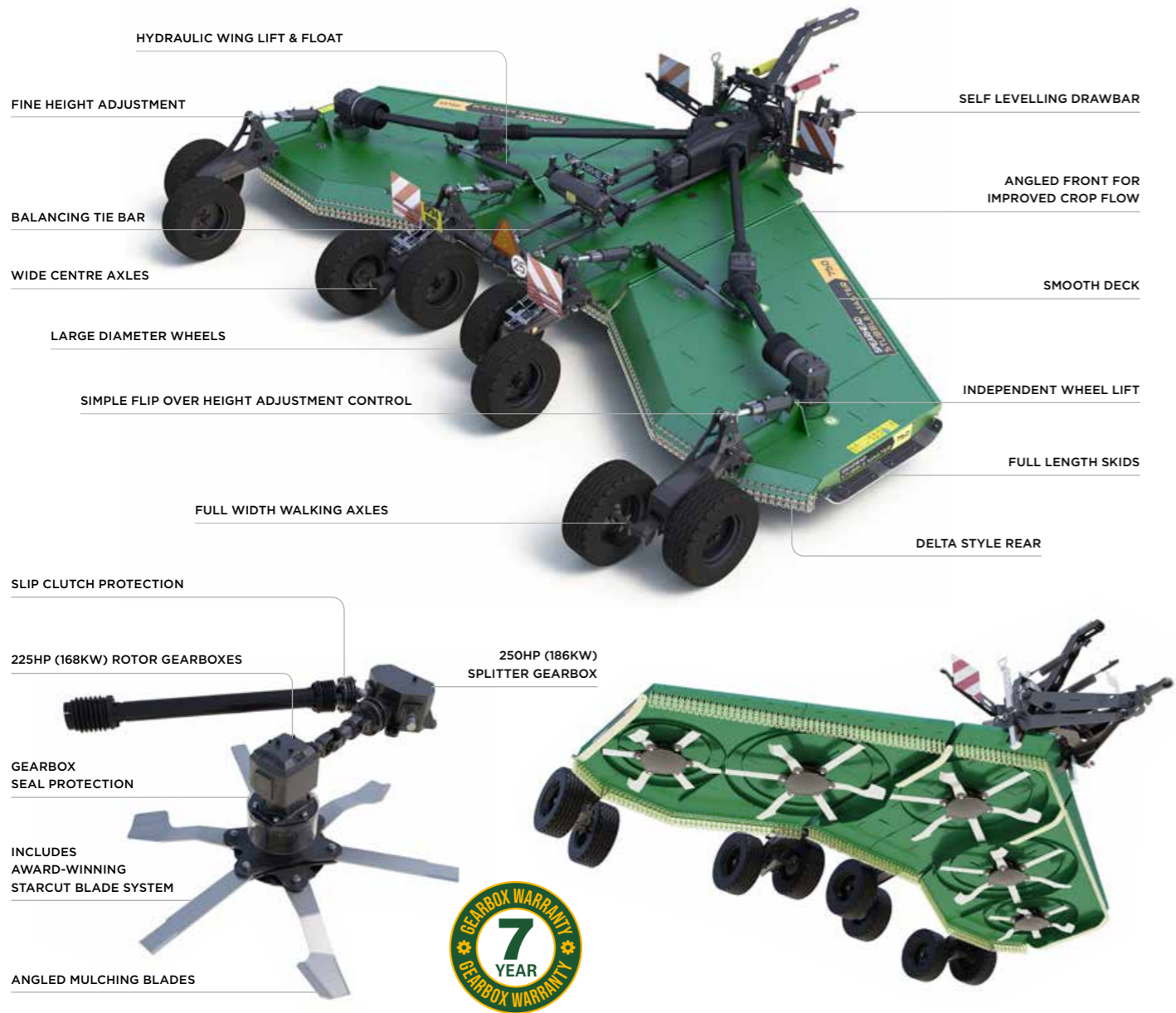

A larger “beefed up” model, the 750 gives you everything the 730 offers with additional durability.

Cutting 7.3 metres at speed, the 225hp (168kW) gearbox is always one step ahead. And five rotors eat into your stubble in whistlestop time. Half the blades are angled to achieve a double cut, flaring the chopped material to mix with soil dust before spreading evenly.

This is a heavy-duty Hardox steel-decked machine you can depend on. Backed by our 7-year gearbox warranty, this unit takes rotary mowing to the next level.

- ▶ A heavy-duty wide area machine.
- ▶ 225hp (168kW) driveline for additional power.
- ▶ Hard wearing specification.



TRACTOR HP	TRANSPORT WIDTH	CUTTING WIDTH	PTO SPEED	GEARBOX RATING	NUMBER OF WHEELS	NUMBER OF ROTORS	NUMBER OF BLADES	CUTTING HEIGHT
160hp (119kW)	3.00m (9' 9")	7.30m (23' 10")	1000rpm	250hp (186kW) & 225hp (168kW)	8	5	30	25 - 400mm (1" - 16")



TRACTOR POWER

160hp (119kW)



CUT WIDTH

7.30m (23' 10")



## OPTIONS



20, 6 OR 21 SPLINE INPUT DRIVESHAFT



STANDARD SWIVEL EYE K80 TOWING EYES



FRONT FLAP KIT



AIR BRAKES



# STUBBLE MASTER 930 HD



This is our largest model with strength to match. Cutting a massive 9.1 metres at once, large-scale farmers, plus aviation and military organisations, welcome its might.

This machine has every feature you need to deliver intensively at speed. It boasts our 225hp (168kW) driveline for maximum power. And five rotors work 30 blades in our famous Starcut formation.

The monocoque design provides incredible strength coupled with sleek top and under decks. This reduces cleaning too as debris has nowhere to hide. You'll look forward to hitching up the Stubble Master 930 HD.

- ▶ Largest, top-end machine for intensive cutting.
- ▶ Power forward with a 225hp (168kW) driveline.
- ▶ Performance boosting specification.

<b>190hp</b> (141kW)	<b>3.00m</b> (9' 9")	<b>9.10m</b> (29' 11")	<b>1000rpm</b>	<b>250hp (186kW)</b> & <b>225hp (168kW)</b>	<b>8*</b>	<b>5</b>	<b>30</b>	<b>25 - 400mm</b> (1" - 16")
-------------------------	-------------------------	---------------------------	----------------	--	-----------	----------	-----------	---------------------------------



**HP**  
TRACTOR POWER  
**190hp**  
(141kW)

CUT WIDTH  
**9.10m**  
(29' 11")

**OPTIONS**

20, 6 OR 21 SPLINE INPUT DRIVESHAFT

STANDARD SWIVEL EYE K80  
TOWING EYES

FRONT & REAR FLAP KIT

AIR BRAKES



# MULTICUT 480 ARMY

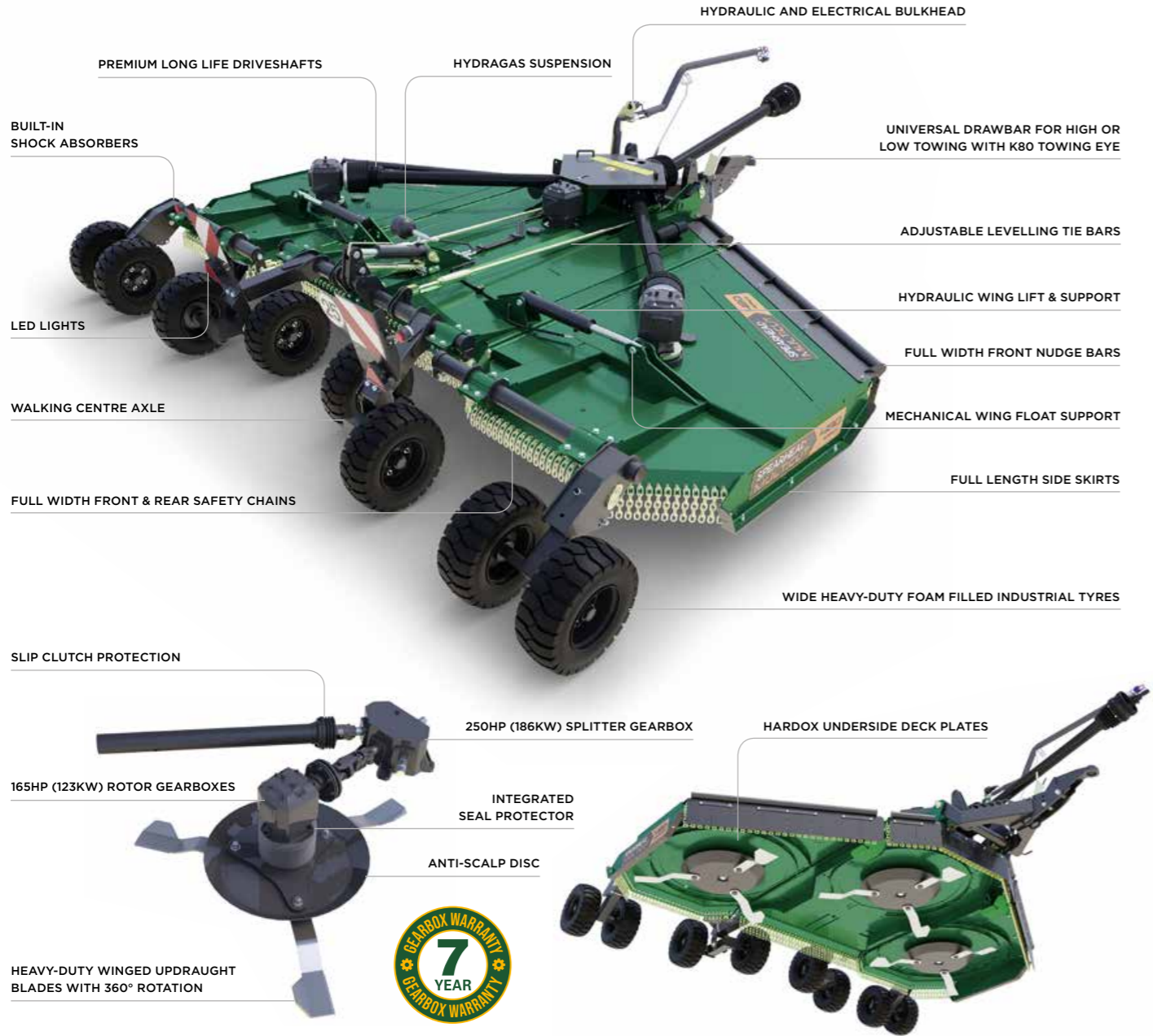

A specialised evolution of a popular machine, Multicut 480 Army has everything to handle life in the military arena.

Front nudge bars provide additional pushing power, driving dense material into the cutting chamber. A bespoke 'stump jumper' blade pan with slashing blades improves cutting in the toughest environments, and foam-filled wheels keep you moving.

Working with military customers, we've thought of everything. Such as enhanced slip clutch protection, specialist hydraulic lines, and independent lift. This ultra-hardy mower is ready to serve.

- ▶ A specialist Multicut 480 for military use.
- ▶ Tackles everything - even minor blast impacts.
- ▶ Modified blade system delivers cutting at speed.

<b>HP</b> TRACTOR HP	<b>2.70m</b> TRANSPORT WIDTH	<b>4.60m</b> CUTTING WIDTH	<b>1000rpm</b> PTO SPEED	<b>250hp (186kW) &amp; 165hp (123kW)</b> GEARBOX RATING	<b>8</b> NUMBER OF WHEELS	<b>3</b> NUMBER OF ROTORS	<b>9</b> NUMBER OF BLADES	<b>25 - 400mm</b> (1" - 16") CUTTING HEIGHT
-------------------------	---------------------------------	-------------------------------	-----------------------------	--	------------------------------	------------------------------	------------------------------	---



**HP**  
TRACTOR POWER  
**100hp**  
(75kW)

**CUT WIDTH**  
**4.60m**  
(15' 1")

OPTIONS



# ARMY MASTER 530

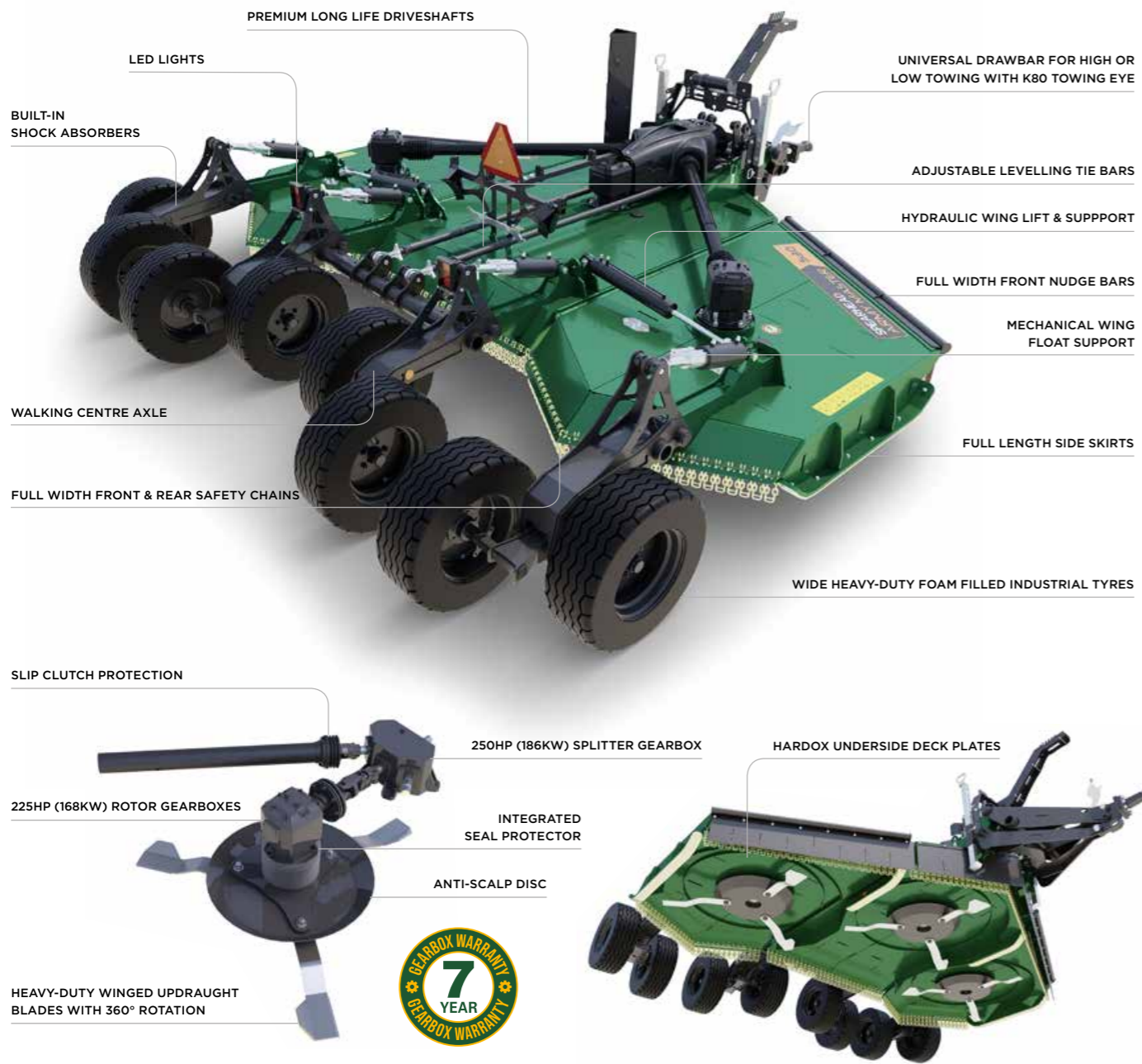

Specifically evolved from the top-end Stubble Master series, Army Master 530 boasts many upgrades. Designed to serve military bases and training sites, it can handle the rough terrain associated with this environment.

The rugged specification includes a 225hp (168kW) driveline and Hardox deck. Meanwhile, super-sized foam filled wheels

and independent lift mean it can go anywhere. Front nudge bars, and a bespoke 'stump jumper' blade pan with slashing blades complete the modifications.

- ▶ Toughened top-end Stubble Master for military use.
- ▶ Capable of severe impact loading.
- ▶ Super-sized foam filled wheels never let you down.

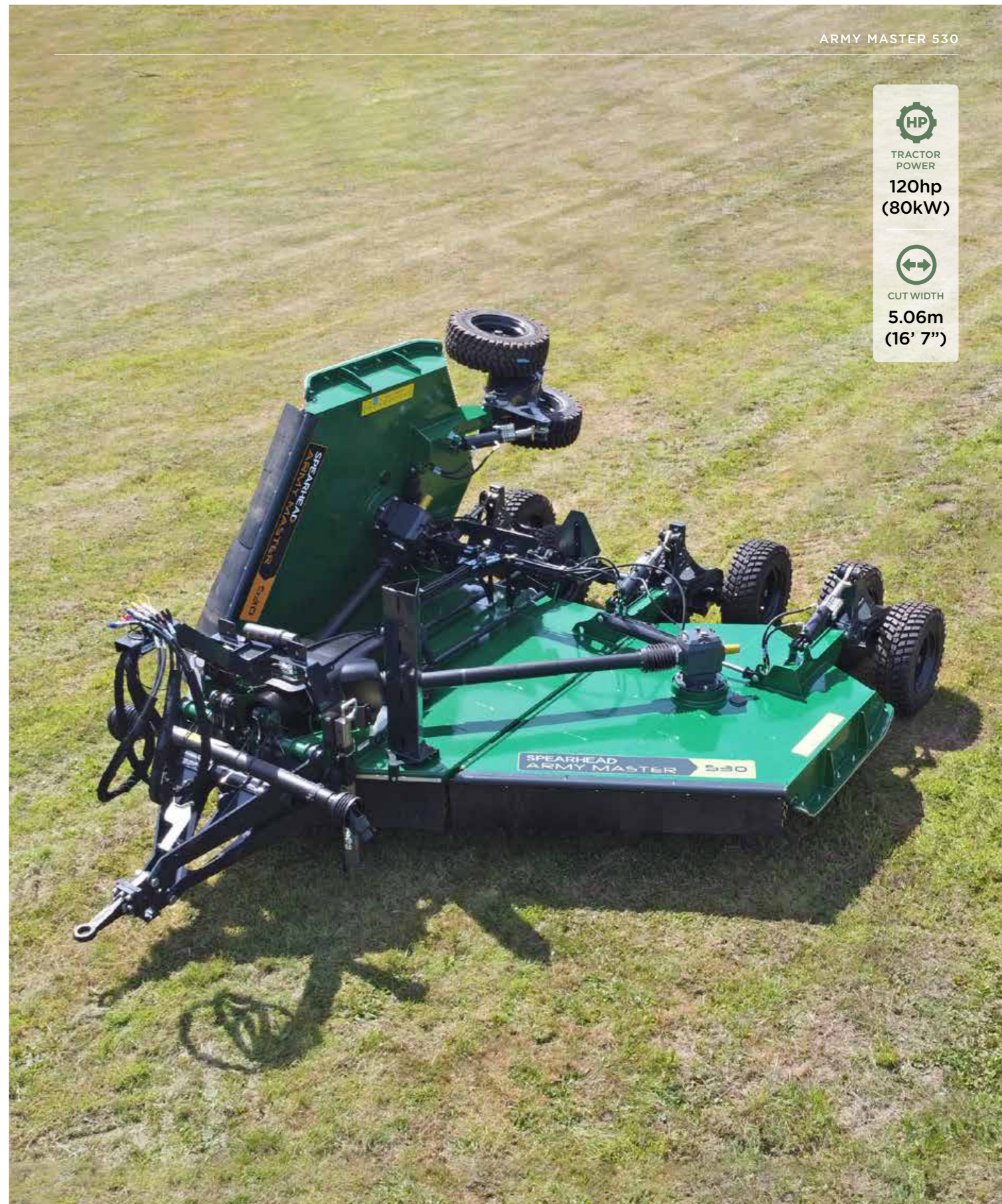

**HP**  
TRACTOR POWER  
**120hp (80kW)**

**CUT WIDTH**  
**5.06m (16' 7")**

<b>SPEARHEAD</b> ARMY MASTER <b>530</b>	<b>TRACTOR HP</b> 120hp (89kW)	<b>TRANSPORT WIDTH</b> 3.00m (9' 9")	<b>CUTTING WIDTH</b> 5.06m (16' 7")	<b>PTO SPEED</b> 1000rpm	<b>GEARBOX RATING</b> 250hp (186kW) & 225hp (168kW)	<b>NUMBER OF WHEELS</b> 8	<b>NUMBER OF ROTORS</b> 3	<b>NUMBER OF BLADES</b> 9	<b>CUTTING HEIGHT</b> 25 - 400mm (1" - 16")
--	-----------------------------------	---	--	-----------------------------	--	------------------------------	------------------------------	------------------------------	--

OPTIONS

**20 6 21**

20, 6, OR 21 SPLINE INPUT DRIVESHAFT

**SWIVEL EYE K80**

TOWING EYES

**AIR BRAKES**

## WHAT SETS SPEARHEAD APART?

The Spearhead Rotary Mower range is the most extensive available.

Spearhead machines contain various features that are built in to improve your output and cutting performance.

At the heart of our product development is a continued desire to deliver the most effective in field performance with best in class chop length, and distribution to ensure the perfect visible finish and a continued benefit to your soil.



## MOUNTING SYSTEM

How your rotary mower attaches to the tractor matters. When changing equipment regularly, you'll welcome a simple and swift manoeuvre. Should your cutting jobs be more intensive and all day long, you might favour more rigidity over a quick hitch.

We offer various mounting types to suit every usage level and rotary model. Let us help you make the right choice.

MULTICUT 300



### THREE POINT LINKAGE

Lighter weight machines up to the Multicut 420 are three-point linkage mounted with Category 1 and 2 compatibility.

#### APPLICABLE MACHINES

- ▶ Multicut 160 / 200 / 300 / 420 models

MULTICUT 480 LOW-SETUP



MULTICUT 480 HIGH-SETUP



STUBBLE MASTER 530HD



### DRAWBAR

Heavier weight machines beginning with the Multicut 480 range are drawbar trailed available with a range of different towing eye fittings to suit the tractor. Some of these drawbars are universal, allowing them to be configured to be compatible for low hitch or high hitch tractors.

#### APPLICABLE MACHINES

- ▶ Multicut 480 / 650 / 830 models
- ▶ All Stubble Master / Army models

## TRAILED TOWING EYES

If your rotary mower is trailed there is a range of linkage to suit. We offer standard eye for lightweight use to specialist eyes. Spearhead leads innovation in linkage because your performance depends on it.

STANDARD EYE



SWIVEL EYE



K80 EYE



## BLADES

We use Boron steel to manufacture our hard wearing rotary blades. They're 12mm (1/2") thick and built for heavy-duty work. You can confidently cut vegetation up to 100mm (4") thick in diameter. With several designs available, the right choice will transform your output.

### STANDARD UPDRAUGHT BLADE

Our signature blade with an aggressive crank and a strong updraught fin. This design promotes ample lift, sucking the chopped material up high. The result is an efficient cut and an exceptional finish.

#### APPLICABLE MACHINES

- ▶ All Multicut models
- ▶ Army Master 530



### STARCUT UPDRAUGHT BLADE

Mainly seen on Stubble Master, this blade provides a more aggressive chopping action. It's particularly effective when smashing and pulverisation are important.

With the cutting area angled downwards, you can cut close to the surface, flaying open the chopped material to speed up decomposition. The design of this blade sucks material into the middle of the rotor and retains it in the cutting chamber for longer increasing mulching output.

#### APPLICABLE MACHINES

- ▶ All Stubble Master models



### STARCUT MULCHING BLADE

Adding another dimension to your cutting, this blade is completely flat. Slightly longer than the updraught blade, its offset angle (above the cutting level) enables a secondary mulching process.

#### APPLICABLE MACHINES

- ▶ Multicut 480 Ecoline (option)
- ▶ All Multicut Proline models
- ▶ All Stubble Master models



## BLADE SYSTEMS

### THREE BLADE EFFICIENCY

Spearhead's world renowned updraught three-blade system is the first choice for heavy working conditions creating suction to lift and pulverise virtually any material.

This can be further improved with the addition of the mulching blades to give for increased crop mulching ability. The Spearhead Starcut system is the ultimate tool for stubble management.

#### APPLICABLE MACHINES

- ▶ Multicut 160 / 200 / 420 models
- ▶ Multicut 480 Ecoline / Army
- ▶ Army Master 530



Multicut 480 Ecoline shown

### TWO BLADE

#### APPLICABLE MACHINES

- ▶ Multicut 300
- ▶ Multicut 420



### STARCUT SIX BLADE

#### APPLICABLE MACHINES

- ▶ Multicut 480 Ecoline (option)
- ▶ All Multicut Proline models
- ▶ All Stubble Master models



CONVENTIONAL BLADE SYSTEM

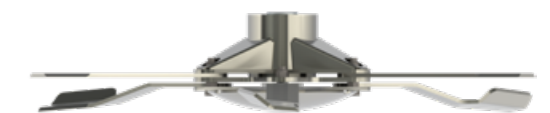

STARCUT BLADE SYSTEM

Improved decomposition - Blades and additional Starcut mulching blades mix fine soil particles with well mulched material. This produces the perfect environment for fast decomposition. It also encourages unwanted volunteers to germinate.

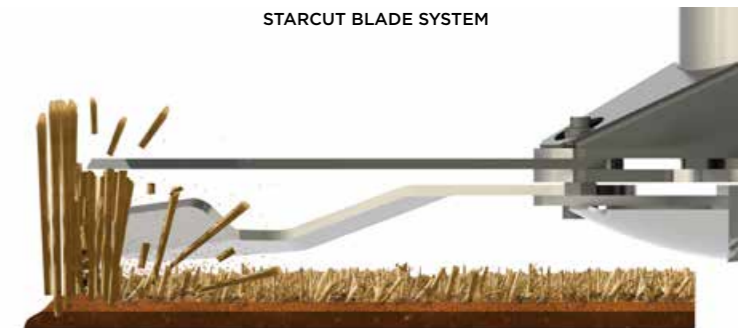

## FLAT UNDERSIDE DECK

Spearhead never compromises finish, and a flat underside deck is testament to that with it considered a staple feature on all our rotary mower designs. With no beams underneath, there's nowhere for material to get lodged. And an open inlet allows material to flow into the deck to ensure optimal cutting capacity.

Without resistance from material blocks, you speed ahead. The job gets done faster and you use less fuel.



Multicut 480 Ecoline shown

The delta-shaped rear means you evenly spread chopped material. Not only does this improve your finish, it speeds up decomposition too.

When competitive brands push you towards a clean top-deck consider why you are buying this machine. Let's ensure that the field looks nice at the end of your days' work and that machine vanity doesn't compromise this.

## HEAVY-DUTY DRIVELINES

We've designed our 165hp (123kW) and 225hp (168kW) gearboxes to last. That's why we're confident to provide a 7-year gearbox warranty as standard.

One of the most significant components of any rotary mower, gearbox damage can be costly. It can also mean unwanted downtime.

That's why we've designed our hardy gearboxes with challenging terrain in mind. Oversized shafts and gears ensure relentless performance, delivering up to 30% more power than competitive gearboxes. Meanwhile, the integrated seal protector keeps the gearbox safe on the toughest terrain.

Our PTO drivelines are also industry leading with longer maintenance intervals and improved clutch properties to ensure loading is managed proportionally.



## FLOW



- 1 **OPEN INLET**  
Allows material to bend under the manifold but not break
  - 2 **FLAT UNDERSIDE**  
Nowhere for material to get lodged
  - 3 **DELTA SHAPED REAR**  
Helps to leave material in an even distribution
- ↓ ↓ ↓
- HIGH EFFICIENCY WITH THE PERFECT FINISH**

## HYDRAGAS SUSPENSION



Available as standard on certain Multicut trailed models, hydragas suspension ensures a smoother ride. Working with the wheels and walking axle, it improves floatation. This, in turn, reduces strain on your machine and helps to maximise its service life.

\*Standard fitment on Multicut Proline and Army models.

## WHEEL AND TYRE OPTIONS

Many wheel and tyre options are available. Your choice depends on how, and where, you intend to use your rotary mower.

Multicut 160 / 200 / 300 / 420 models



Multicut 480 Ecoline

- ▶ Multicut 480 Proline
- ▶ Multicut 480 Army
- ▶ Multicut 650 Proline

- ▶ Multicut 660HD
- ▶ Multicut 830 Proline
- ▶ Stubble Master

- ▶ Stubble Master HD
- ▶ Army Master 530

## TRAILED AXLE OPTIONS



### STANDARD AXLE

The standard axle found on the Multicut 480 Ecoline allows for even support and reduced ground compaction in soft ground conditions and strength and stability when in transport.



### WALKING AXLE

The higher specification centre walking axle found on Multicut Proline, Stubble Master and all Army specification machines allow the machine wheels to pivot and follow ground contours more easily with an aim of producing a better quality finish along with providing the machine with increased stability in uneven terrain.

Larger width machines feature the addition of walking wing axles to give further ground following ability to their extended width.

## HEIGHT ADJUSTMENT



### MULTICUT MOUNTED MODELS

The Multicut mounted range cutting heights are adjusted by moving the wheel arms into the different holes found in the machine deck. They are secured in position by pins for easy adjustment changes without the need for tools.

### MULTICUT TRAILED MODELS

The Multicut trailed range cutting heights are adjusted by using a centre axle height sleeve to limit the lowering of the hydraulic ram. They are secured in position by pins for easy adjustment changes without the requirement of tools.

Wing axle settings can be set accurately with the use of axle links between the centre and wing axles. Forward to rear pitch adjustment can be set correctly through the adjustment of the dual tie bars between the front and rear of the machine.

### MULTICUT 660HD / STUBBLE MASTER / ARMY MASTER MODELS

The Multicut 660HD, Stubble Master and Army Master range cutting heights are adjusted by using "flip-over" spacers to limit the lowering of each of independent hydraulic rams on each axle without the requirement of tools.

Wing axle settings can be set accurately with the use of adjustable length hydraulic rams. A combination of dual tie bars and drawbar parallel linkage ensures a correct pitch and level movement when the machine is raised and lowered.



For full machine dimensions please scan the code or visit [www.spearheadmachinery.com/dimensions](http://www.spearheadmachinery.com/dimensions)

## MULTICUT MACHINES

STANDARD SPECIFICATION	MULTICUT 160	MULTICUT 200	MULTICUT 300
<b>FEATURES</b>			
Machine weight*	540kg (1190lb)	635kg (1400lbs)	990kg (2183lbs)
Minimum weight guide	2900kg (6394lbs)	2900kg (6394lbs)	4000kg (8819lbs)
Hitch	Category 1/2 with floating clevis top link	Category 1/2 with floating clevis top link	Category 2 with floating clevis top link
Cutting width	1.60m (5' 3")	2.00m (6' 6")	2.80m (9' 4")
Overall width	1.79m (5' 11")	2.08m (6' 10")	3.03m (10')
Overall length	2.73m (9')	3.02m (9' 11")	2.73m (9')
Deck height**	0.24m (10")	0.24m (10")	0.24m (10")
Transport height	-	-	-
Cutting height	50mm - 250mm (2" - 8")	50mm - 250mm (2" - 8")	10mm - 350mm (1/2" - 14")
Cutting capacity	100mm (4")	100mm (4")	100mm (4")
Recommended tractor HP	40hp (30kW)	45hp (30kW)	50hp (37kW)
Wing working angles	-	-	-
Power take-off speed	540rpm	540rpm	1000rpm (540rpm optional)
<b>GEARBOX</b>			
Gearbox(es)	1 x Cast Iron housing	1 x Cast Iron housing	3 x Cast Iron housing
Input shaft	1 3/8" Z6 input shaft	1 3/8" Z6 input shaft	1 3/8" Z6 input shaft
Gearbox lubricant [rotor]	85W-140 oil	85W-140 oil	85W-140 oil
Gearbox lubricant [splitter]	-	-	EP80-90W or GL-4 / GL-5 oil
Gearbox oil capacity [splitter gearbox]	-	-	1.7 litres (3.0 pints)
Gearbox oil capacity [rotor gearboxes]	4.3 litres (7.6 pints)	4.3 litres (7.6 pints)	2 x 4.3 litres (7.6 pints)
<b>CONSTRUCTION</b>			
Deck construction	All welded construction	All welded construction	All welded construction
Deck material thickness	5mm (3/16")	5mm (3/16")	5mm (3/16")
Side skirt material thickness	6mm (1/4")	6mm (1/4")	6mm (1/4")
Skid construction	Replaceable bolt on skid shoes	Replaceable bolt on skid shoes	Replaceable bolt on skid shoes
<b>BLADES</b>			
Anti-scalp dish	6mm (1/4") round pan with blade holder bar	6mm (1/4") round pan with blade holder bar	5mm (3/16") round pan with blade holder bar
Blades standard	3 x 12mm (1/2") 30 Carbon Boron hardened and tempered. Free swinging high lift - low friction	3 x 12mm (1/2") 30 Carbon Boron hardened and tempered. Free swinging high lift - low friction	4 x 10mm (3/8") 30 Carbon Boron hardened and tempered. Free swinging high lift - low friction
Blade bolts	M24 C/W shank grade 8.8	M24 C/W shank grade 8.8	M24 C/W shank grade 8.8
Blade tip speed	87mps (17126fpm)	85mps (16732fpm)	85mps (16734fpm)
<b>DRIVELINE</b>			
Driveline	ASAE Category 4	ASAE Category 4	ASAE Category 4
Driveline protection	2 plate slip clutch	2 plate slip clutch	Automatic torque limiter
Tailwheel mount assemblies	Welded box section arm and caster fork with 360° swivel	Welded box section arm and caster fork with 360° swivel	Welded box section arms and caster forks with 360° swivels
Tailwheels	5.00-8 rubber tyre with steel rim	5.00-8 rubber tyre with steel rim	2 x 5.00-8 rubber tyre with steel rim
Front guard	Looped chain guard	Looped chain guard	Single chain guard
Rear guard	Looped chain guard	Looped chain guard	Single chain guard

\*Weights may vary dependent on machine specification

46 \*\*Underside of deck to skid

## MULTICUT MACHINES

STANDARD SPECIFICATION	MULTICUT 420	MULTICUT 480 ECOLINE	MULTICUT 480 PROLINE
<b>FEATURES</b>			
Machine weight*	1875kg (4134lbs)	2500kg (5512lbs)	2690kg (5930lbs)
Minimum weight guide	5500kg (12126lbs)	-	-
Hitch	Category 2 with floating clevis top link	Multi-positional drawbar	Multi-positional drawbar
Cutting width	4.25m (14')	4.60m (15' 1")	4.60m (15' 1")
Working machine width	4.71m (15' 6")	4.79m (15' 9")	4.79m (15' 9")
Transport machine width	2.91m (9' 7")	2.70m (8' 11")	2.70m (8' 11")
Maximum working length	3.62m (11' 11")	4.91m (16' 2")	4.91m (16' 2")
Transport length	3.62m (11' 11")	4.84m (15' 11")	4.83m (15' 11")
Deck height**	0.32m (1' 1")	0.23m (9")	0.23m (9")
Transport height	2.07m (6' 10")	2.17m (7' 2")	2.06m (6' 9")
Cutting height	25mm - 400mm (1" - 1' 4")	25mm - 400mm (1" - 16")	25mm - 400mm (1" - 16")
Cutting capacity	100mm (4")	100mm (4")	100mm (4")
Recommended tractor HP	80hp (60kW)	70hp (52kW)	100hp (75kW)
Wing working angles	15° up / 7° down	45° up / 15° down	45° up / 15° down
Power take-off speed	1000rpm	1000rpm (540rpm optional)	1000rpm (540rpm optional)
<b>GEARBOX</b>			
Gearbox(es)	3 x Cast iron housing	4 x Cast Iron housing	4 x Cast Iron housing
Input shaft	1 3/8" Z6 input shaft	1 3/8" Z21 or Z6 SFT 6/8 tractor end	1 3/8" Z21 or Z6 SFT 6/8 tractor end
Gearbox lubricant [rotor]	Lithium EP000 semi fluid grease	85W-140 oil	85W-140 oil
Gearbox lubricant [splitter]	Lithium EP000 semi fluid grease	EP80-90W or GL-4 / GL-5 oil	EP80-90W or GL-4 / GL-5 oil
Gearbox oil capacity [splitter gearbox]	TBC	2.7 litres (4.7 pints)	2.7 litres (4.7 pints)
Gearbox oil capacity [centre gearboxes]	TBC	4.3 litres (7.6 pints)	4.3 litres (7.6 pints)
Gearbox oil capacity [rotor gearboxes]	TBC	2 x 4.3 litres (7.6 pints)	2 x 4.3 litres (7.6 pints)
<b>CONSTRUCTION</b>			
Deck construction	All welded construction	All welded construction	All welded construction
Deck material thickness	4mm (3/16")	6mm (1/4")	6mm (1/4")
Side skirt material thickness	6mm (1/4")	5mm (3/16")	5mm (3/16")
Skid construction	Replaceable bolt on skid shoes	Replaceable bolt on skid shoes	Replaceable bolt on skid shoes
<b>BLADES</b>			
Anti-scalp dish	5mm (3/16") round pan with blade holder bar	6mm (1/4") round pan with blade holder bar	6mm (1/4") round pan with blade holder bar
Blades standard	6 x 10mm (3/8") 30 Carbon Boron hardened and tempered. Free swinging high lift - low friction	9 x 12mm (1/2") 30 Carbon Boron hardened and tempered. Free swinging high lift - low friction	9 x 12mm (1/2") 30 Carbon Boron hardened and tempered. Free swinging high lift - low friction. Handed
Blades Starcut	-	-	9 x 12mm (1/2") 30 Carbon Boron hardened and tempered. Free swinging low friction. Non-handed
Blade bolts	M24 C/W shank grade 8.8	M24 C/W shank grade 8.8	M24 C/W shank grade 8.8
Blade tip speed	75 m/s (14764 fpm)	80mps (15748fpm)	80mps (15748fpm)
<b>DRIVELINE</b>			
Driveline	ASAE Category 4	ASAE Category 4	ASAE Category 4
Driveline protection	Overrun clutch on input PTO shaft and 2-plate slip clutches on wing driveshafts	2-way slip clutches on rotor gearboxes. Overrun on input shaft	2-way slip clutches on rotor gearboxes. Overrun on input shaft
Tailwheel mount assemblies	Welded box section arms and caster forks with 360° swivels	Tubular welded axle	Tubular welded axle
Tailwheels	4 x 5.00-8 rubber tyre with steel hub	8 x 600-9 10 PLY pneumatic tyre with steel rim	8 x 21 x 9 14 PLY pneumatic tyre with steel rim
Front guard	Single chain guards on each deck	Single chain guards on each deck	Single chain guards on each deck
Rear guard	Single chain guards on each deck	Single chain guards on each deck	Single chain guards on each deck

\*Weights may vary dependent on machine specification

47 \*\*Underside of deck to skid



## MULTICUT MACHINES

STANDARD SPECIFICATION	MULTICUT 650 PROLINE	MULTICUT 660HD	MULTICUT 830 PROLINE
<b>FEATURES</b>			
Machine weight	3300kg (7275lbs)	3550kg (7826lbs)	4800kg (10582lbs)
Hitch	Multi-positional drawbar	Multi-positional drawbar	Multi-positional drawbar
Cutting width	6.28m (20' 7")	6.38m (20' 11")	8.06m (26' 5")
Working machine width	6.47m (21' 3")	6.58m (21' 7")	8.26m (27' 1")
Transport machine width	2.70m (8' 11")	2.46m (8')	2.81m (9' 3")
Maximum working length	5.07m (16' 8")	6.12m (20' 1")	6.33m (20' 9")
Transport length	4.93m (16' 3")	6.03m (19' 10")	6.07m (19' 11")
Deck height**	0.23m (9")	0.23m (9")	0.24m (10")
Transport height	2.90m (9' 7")	2.94m (9' 8")	3.78m (12' 5")
Cutting height	25mm - 210mm (1" - 8 1/4")	25mm - 400mm (1" - 16")	25 - 400mm (1" - 16")
Cutting capacity	100mm (4")	100mm (4")	100mm (4")
Recommended tractor HP	90hp (67kW)	90hp (67kW)	150hp (112kW)
Wing working angles	45° up / 15° down	45° up / 15° down	45° up / 15° down
Power take-off speed	1000rpm	1000rpm	1000rpm
<b>GEARBOX</b>			
Gearbox(es)	6 x Cast Iron housing	6 x Cast Iron housing	6 x Cast Iron housing
Input shaft	1 3/8" Z21 or Z6 SFT 8 tractor end	1 3/8" Z21 or Z6 SFT 8 tractor end	1 3/8" Z20 SFT 10 tractor end
Gearbox lubricant [rotor]	85W-140 oil	85W-140 oil	85W-140 oil
Gearbox lubricant [splitter]	EP80-90W or GL-4 / GL-5 oil	EP80-90W or GL-4 / GL-5 oil	EP80-90W or GL-4 / GL-5 oil
Gearbox oil capacity [splitter gearbox]	2.7 litres (4.7 pints)	2.7 litres (4.7 pints)	2.7 litres (4.7 pints)
Gearbox oil capacity [centre gearbox]	4.3 litres (7.6 pints)	4.3 litres (7.6 pints)	TBC
Gearbox oil capacity [rotor gearboxes]	4 x 4.3 litres (7.6 pints)	4 x 4.3 litres (7.6 pints)	4 x 4.3 litres (7.6 pints)
<b>CONSTRUCTION</b>			
Deck construction	All welded construction	All welded construction	All welded construction
Deck material thickness	6mm (1/4")	5mm (3/16")	5mm (3/16")
Side skirt material thickness	5mm (3/16")	5mm (3/16")	6mm (1/4")
Skid construction	Replaceable bolt on skid shoes	Replaceable bolt on skid shoes	Replaceable bolt on skid shoes
<b>BLADES</b>			
Anti-scalp dish	6mm (1/4") round pan with blade holder bar	6mm (1/4") round pan with blade holder bar	6mm (1/4") round pan with blade holder bar
Blades standard	15 x 12mm (1/2") 30 Carbon Boron hardened and tempered. Free swinging high lift - low friction	15 x 12mm (1/2") 30 Carbon Boron hardened and tempered. Free swinging high lift - low friction	15 x 12mm (1/2") 30 Carbon Boron hardened and tempered. Free swinging high lift - low friction
Blades Starcut	15 x 12mm (1/2") 30 Carbon Boron hardened and tempered. Free swinging low friction. Non-handed	15 x 12mm (1/2") 30 Carbon Boron hardened and tempered. Free swinging low friction. Non-handed	15 x 12mm (1/2") 30 Carbon Boron hardened and tempered. Free swinging low friction. Non-handed
Blade bolts	M24 C/W shank grade 8.8	M24 C/W shank grade 8.8	M24 C/W shank grade 8.8
Blade tip speed	79mps (15551fpm)	79mps (15551fpm)	79mps (15551fpm)
<b>DRIVELINE</b>			
Driveline	ASAE Category 6	ASAE Category 8	ASAE Category 10
Driveline protection	2/4-way slip clutches on rotor gearboxes. Overrun on input shaft	2/4-way slip clutches on rotor gearboxes. Overrun on input shaft	2/4-way slip clutches on rotor gearboxes. Overrun on input shaft
Tailwheel mount assemblies	Tubular welded walking axles	Tubular welded walking axles	Tubular welded walking axles
Tailwheels	8 x 21 x 9 14 PLY pneumatic tyre with steel rim	10.0 / 80 x 12 - AW - 909 TL 10 PLY pneumatic tyre with steel rim***	10.0 / 80 x 12 - AW - 909 TL 10 PLY pneumatic tyre with steel rim***
Front guard	Single chain guards on each deck	Single chain guards on each deck	Single chain guards on each deck
Rear guard	Single chain guards on each deck	Single chain guards on each deck	Single chain guards on each deck

\*Weights may vary dependent on machine specification

\*\*Underside of deck to skid

48 \*\*\*Standard fitment, other options available

## STUBBLE MASTER MACHINES

STANDARD SPECIFICATION	STUBBLE MASTER 500	STUBBLE MASTER 730	STUBBLE MASTER 530 HD
<b>FEATURES</b>			
Machine weight	2920kg (6438lbs)	5500kg (12125lbs)	4340kg (9568lbs)
Hitch	Multi-positional drawbar	Multi-positional drawbar	Multi-positional drawbar
Cutting width	5.06m (16' 7")	7.26m (23' 11")	5.06m (16' 7")
Working machine width	5.20m (17' 1")	7.53m (24' 9")	5.30m (17' 5")
Transport machine width	2.97m (9' 9")	2.56m (8' 5")	2.60m (8' 7")
Maximum working length	5.83m (19' 2")	6.48m (21' 4")	5.95m (19' 7")
Transport length	5.78m (19')	6.41m (21' 1")	5.90m (19' 5")
Transport height	2.19m (7' 3")	3.44m (11' 4")	2.40m (7' 11")
Deck height**	0.26m (11")	0.26m (11")	0.33m (1' 1")
Cutting height	25mm - 400mm (1" - 16")	25mm - 400mm (1" - 16")	25mm - 400mm (1" - 16")
Cutting capacity	100mm (4")	100mm (4")	100mm (4")
Recommended tractor HP	120hp (89kW)	160hp (119kW)	120hp (89kW)
Wing working angles	30° up / 7.5° down	30° up / 7.5° down	30° up / 7.5° down
Power take-off speed	1000rpm	1000rpm	1000rpm
<b>GEARBOX</b>			
Gearbox(es)	4 x Cast Iron housing	6 x Cast Iron housing	4 x Cast Iron housing
Input shaft	1 3/8" Z21 or Z6 SFT 8 tractor end or 1 3/4" Z20 or Z6 SFT 8 tractor end	1 3/8" Z21 or Z6 SFT 8 tractor end or 1 3/4" Z20 or Z6 SFT 8 tractor end	1 3/8" Z21 or Z6 SFT 8 tractor end or 1 3/4" Z20 or Z6 SFT 8 tractor end
Gearbox lubricant [splitter]	EP80-90W or GL-4 / GL-5 oil	EP80-90W or GL-4 / GL-5 oil	EP80-90W or GL-4 / GL-5 oil
Gearbox lubricant [rotor]	85W-140 oil	85W-140 oil	85W-140 oil
Gearbox oil capacity [splitter gearbox]	3.5 litres (6.2 pints)	3.5 litres (6.2 pints)	3.5 litres (6.2 pints)
Gearbox oil capacity [rotor gearboxes]	3 x 4.3 litres (7.6 pints)	5 x 4.3 litres (7.6 pints)	3 x TBC
<b>CONSTRUCTION</b>			
Deck construction	All welded construction	All welded construction	All welded construction
Deck material thickness	3mm (1/8")	3mm (1/8")	5mm (3/16")
Side skirt material thickness	8mm (5/16")	8mm (5/16")	5mm (3/16")
Skid construction	Replaceable bolt on skid shoes	Replaceable bolt on skid shoes	Replaceable bolt on skid shoes
<b>BLADES</b>			
Anti-scalp dish	5mm (3/16") round pan with blade holder bar	5mm (3/16") round pan with blade holder bar	5mm (3/16") round pan with blade holder bar
Blades standard	9 x 12mm (1/2") 30 Carbon Boron hardened and tempered. Free swinging high lift - low friction. Handed.	15 x 12mm (1/2") 30 Carbon Boron hardened and tempered. Free swinging high lift - low friction. Handed.	9 x 12mm (1/2") 30 Carbon Boron hardened and tempered. Free swinging high lift - low friction. Handed.
Blades Starcut	9 x 12mm (1/2") 30 Carbon Boron hardened and tempered. Free swinging high lift - low friction. Non-handed.	15 x 12mm (1/2") 30 Carbon Boron hardened and tempered. Free swinging high lift - low friction. Non-handed.	9 x 12mm (1/2") 30 Carbon Boron hardened and tempered. Free swinging high lift - low friction. Non-handed.
Blade bolts	M24 C/W shank grade 8.8	M24 C/W shank grade 8.8	M24 C/W shank grade 8.8
Blade tip speed	80mps / 15748fpm	81mps / 15944fpm	80mps / 15748fpm
<b>DRIVELINE</b>			
Driveline	ASAE Category 4	ASAE Category 8	ASAE Category 6
Driveline protection	2-way slip clutches on rotor gearbox. Overrun on input shaft	2/4-way slip clutches on rotor gearboxes. Overrun on input shaft	2-way slip clutches on rotor gearbox. Overrun on input shaft
Tailwheel mount assemblies	Tubular welded walking axles	Tubular welded walking axles	Tubular welded walking axles
Tailwheels	8 x 265/70 R16.5 stubble resistant tyre with steel rim on rear	8 x 265/70 R16.5 stubble resistant tyre with steel rim on rear	8 x 265/70 R16.5 stubble resistant tyre with steel rim on rear
Front guard	Single chain guards on each deck	Single chain guards on each deck	Single chain guards on each deck
Rear guard	Single chain guards on each deck	Single chain guards on each deck	Single chain guards on each deck

\*Weights may vary dependent on machine specification

\*\*Underside of deck to skid 49

## STUBBLE MASTER MACHINES

STANDARD SPECIFICATION	STUBBLE MASTER 750 HD	STUBBLE MASTER 930 HD
<b>FEATURES</b>		
Machine weight	5500kg (12125lbs)	9800kg (21605lbs)
Hitch	Multi-positional drawbar	Multi-positional drawbar
Cutting width	7.29m (23' 11")	9.10m (29' 11")
Transport machine width	2.56m (8' 5")	2.84m (9' 4")
Working machine width	7.53m (24' 9")	9.38m (30' 10")
Maximum working length	6.48m (21' 4")	6.99m (23')
Transport length	6.41m (21' 1")	6.82m (22' 5")
Transport height	3.44m (11' 4")	3.72m (12' 3")
Deck height**	0.33m (1' 1")	0.35m (1' 2")
Cutting height	25mm - 400mm (1" - 16")	25mm - 400mm (1" - 16")
Cutting capacity	100mm (4")	100mm (4")
Recommended tractor HP	160hp (119kW)	190hp (142kW)
Wing working angles	30° up / 7.5° down	15° up / 5° down
Power take-off speed	1000rpm	1000rpm
<b>GEARBOX</b>		
Gearbox(es)	6 x Cast Iron housing	6x Cast Iron housing
Input shaft	1 3/8" Z21 or Z6 SFT 8 tractor end or 1 3/4" Z20 or Z6 SFT 8 tractor end	1 3/4" Z20 SFT tractor end
Gearbox lubricant [splitter]	EP80-90W or GL-4 / GL-5 oil	EP80-90W or GL-4 / GL-5 oil
Gearbox lubricant [rotor]	85W-140 oil	EP80-90W or GL-4 / GL-5 oil
Gearbox oil capacity [splitter gearbox]	3.5 litres (6.2 pints)	2.7 litres (4.7 pints)
Gearbox oil capacity [rotor gearboxes]	5 x TBC	5 x 2.1 litres (3.7 pints)
<b>CONSTRUCTION</b>		
Deck construction	All welded construction	All welded construction
Deck material thickness	5mm (3/16")	5mm (3/16")
Side skirt material thickness	5mm (3/16")	13mm (1/2")
Skid construction	Replaceable bolt on skid shoes	Replaceable bolt on skid shoes
<b>BLADES</b>		
Anti-scalp dish	5mm (3/16") round pan with blade holder bar	5mm (3/16") round pan with blade holder bar
Blades standard	15 x 12mm (1/2") 30 Carbon Boron hardened and tempered. Free swinging high lift - low friction. Handed.	15 x 12mm (1/2") 30 Carbon Boron hardened and tempered. Free swinging high lift - low friction. Handed.
Blades Starcut	15 x 12mm (1/2") 30 Carbon Boron hardened and tempered. Free swinging high lift - low friction. Non-handed	15 x 12mm (1/2") 30 Carbon Boron hardened and tempered. Free swinging high lift - low friction. Non-handed.
Blade bolts	M24 C/W shank grade 8.8	M24 C/W shank grade 8.8
Blade tip speed	81mps (15944fpm)	88mps (17322fpm)
<b>DRIVELINE</b>		
Driveline	ASAE Category 8	ASAE Category 10
Driveline protection	2/4-way slip clutches on rotor gearboxes. Overrun on input shaft	2/4-way slip clutches on rotor gearboxes. Overrun on input shaft
Tailwheel mount assemblies	Tubular welded walking axles	Tubular welded walking axles
Tailwheels	8 x 265/70 R16.5 stubble resistant tyre with steel rim on rear	8 x 305/70 R16.5 stubble resistant tyre with steel rim on rear x2 on front
Front guard	Single chain guards on each deck	Single chain guards on each deck
Rear guard	Single chain guards on each deck	Single chain guards on each deck

\*Weights may vary dependent on machine specification

50 \*\*Underside of deck to skid

## MILITARY MACHINES

STANDARD SPECIFICATION	MULTICUT 480 ARMY	ARMY MASTER 530
<b>FEATURES</b>		
Machine weight*	2690kg (5930lbs)	4720kg (10406lbs)
Hitch	Multi-positional drawbar	Multi-positional drawbar
Cutting width	4.60m (15' 1")	5.06m (16' 7")
Transport machine width	2.70m (8' 11")	2.60m (8' 7")
Working machine width	4.79m (15' 9")	5.30m (17' 5")
Maximum working length	4.91m (16' 2")	5.95m (19' 7")
Transport length	4.83m (15' 11")	5.90m (19' 5")
Transport height	2.06m (6' 9")	2.40m (7' 11")
Deck height**	0.23m (9")	0.33m (1' 1")
Cutting height	25mm - 400mm (1" - 16")	25mm - 400mm (1" - 16")
Cutting capacity	100mm (4")	100mm (4")
Recommended tractor HP	100hp (75kW)	120hp (89kW)
Wing working angles	45° up / 15° down	30° up / 7.5° down
Power take-off speed	1000rpm	1000rpm
<b>GEARBOX</b>		
Gearbox(es)	4 x Cast Iron housing	4 x Cast Iron housing
Input shaft	1 3/8" Z21 or Z6 SFT 6/8 tractor end	1 3/8" Z21 or Z6 SFT 6/8 tractor end
Gearbox lubricant [splitter]	EP80-90W or GL-4 / GL-5 oil	EP80-90W or GL-4 / GL-5 oil
Gearbox lubricant [rotor]	85W-140 oil	85W-140 oil
Gearbox oil capacity [splitter gearbox]	2.7 litres (4.7 pints)	2.7 litres (4.7 pints)
Gearbox oil capacity [centre gearbox]	4.3 litres (7.6 pints)	TBC
Gearbox oil capacity [rotor gearboxes]	2 x 4.3 litres (7.6 pints)	2 x TBC
<b>CONSTRUCTION</b>		
Deck construction	All welded construction	All welded construction
Deck material thickness	6mm (1/4")	5mm (3/16")
Side skirt material thickness	5mm (3/16")	5mm (3/16")
Skid construction	Replaceable bolt on skid shoes	Replaceable bolt on skid shoes
<b>BLADES</b>		
Dishpan	6mm (1/4") round pan with blade holder bar	6mm (1/4") round pan with blade holder bar
Blades standard	9 x 10mm (3/8") 30 Carbon Boron hardened and tempered. Free swinging high lift - low friction. Handed	9 x 10mm (3/8") 30 Carbon Boron hardened and tempered. Free swinging high lift - low friction. Handed
Blade bolts	M24 C/W shank grade 8.8	M24 C/W shank grade 8.8
Blade tip speed	80mps (15748fpm)	80mps (15748fpm)
<b>DRIVELINE</b>		
Driveline	ASAE Category 4	ASAE Category 4
Driveline protection	2-way slip clutches on rotor gearboxes. Overrun on input shaft	2-way slip clutches on rotor gearboxes. Overrun on input shaft
Tailwheel mount assemblies	Tubular welded walking axles	Tubular welded walking axles
Tailwheels	8 x 21 x 9 14 PLY foam-filled pneumatic tyre with steel rim	8 x 265/70 R16.5 foam-filled stubble resistant tyre with steel rim
Front guard	Single chain guards on each deck with nudge bar and rubber flap	Single chain guards on each deck with nudge bar and rubber flap
Rear guard	Single chain guards on each deck	Single chain guards on each deck

\*Weights may vary dependent on machine specification

\*\*Underside of deck to skid 51

# SPEARHEAD

Station Road, Salford Priors, Evesham, Worcestershire, WR11 8SW, England  
☎ +44 (0)1789 491860 ✉ enquiries@spearheadmachinery.com f 🐦 SpearheadWorld

[spearheadmachinery.com](http://spearheadmachinery.com)



designed and built in  
**GREAT BRITAIN**



A Member of the **ALAMO GROUP**

All information in this brochure is correct at the time of printing. Spearhead Machinery Limited reserves the right to change any of the data or descriptions at any time without prior warning. All dimensions are for reference.